



136 North Monroe Street
Waterloo, WI 53594-1198
Phone: (920) 478-3025
Fax: (920) 478-2021
www.waterloowi.us

PUBLIC NOTICE OF A COMMITTEE MEETING OF THE COMMON COUNCIL OF THE CITY OF WATERLOO

Pursuant to Section 19.84 Wisconsin Statutes, notice is hereby given to the public & news media, that the following meeting will be held:

COMMITTEE: PUBLIC WORKS & PROPERTY COMMITTEE
DATE: February 1, 2024
TIME: 6:00 p.m.
LOCATION: Municipal Building Council Chambers, 136 N. Monroe Street

- 1) COMMITTEE REGULARLY SCHEDULED MEETING
- 2) PLEDGE OF ALLEGIANCE, CALL TO ORDER AND ROLL CALL
- 3) APPROVAL OF MEETING MINUTES – December 7, 2023
- 4) CITIZEN INPUT / PUBLIC COMMENT (3 minutes per individual)
- 5) PROJECT OVERSIGHT & UPDATES
- 6) UNFINISHED BUSINESS
 - a) 2024-05 DEAD, DISEASED OR HAZARDOUS TREES ON PRIVATE PROPERTY 332-5 AND 332-7 (returned from attorney)
- 7) NEW BUSINESS
 - a) 2023 WISLR Report
 - b) Municipal Building Parking Lot
- 8) FUTURE AGENDA ITEMS AND ANNOUNCEMENTS -- Committee Calendar
- 9) ADJOURNMENT

Jeanne Ritter
Clerk/Deputy Treasurer

Committee Members: Weihert, Haseleu, and A. Kuhl

posted, e-mailed & distributed: 1/26/2024

PLEASE NOTE: IT IS POSSIBLE THAT MEMBERS OF AND POSSIBLY A QUORUM OF MEMBERS OF OTHER GOVERNMENTAL BODIES OF THE MUNICIPALITY MAY BE IN ATTENDANCE AT THE ABOVE MEETING(S) TO GATHER INFORMATION. NO ACTION WILL BE TAKEN BY ANY GOVERNMENTAL BODY OTHER THAN THAT SPECIFICALLY NOTICED. ALSO, UPON REASONABLE NOTICE, EFFORTS WILL BE MADE TO ACCOMMODATE THE NEEDS OF DISABLED INDIVIDUALS THROUGH APPROPRIATE AIDS AND SERVICES. FOR ADDITIONAL INFORMATION OR TO REQUEST SUCH SERVICES PLEASE CONTACT THE CLERK'S OFFICE AT THE ABOVE LOCATION.

CITY OF WATERLOO
PUBLIC WORKS & PROPERTY COMMITTEE MEETING MINUTES: December 7, 2023
Digital audio files are archived with these written minutes additionally serving as the official record.

COMMITTEE REGULARLY SCHEDULED MEETING

1. PLEDGE OF ALLEGIANCE, CALL TO ORDER AND ROLL CALL. Weihert called the meeting to order at 6:30 pm. Committee members present: A. Kuhl, Haseleu & Weihert. Absent: none Others in attendance: Mayor Quimby; Alderperson C.Kuhl; Alderperson Thomas; DPW Yerges; Police Chief Cummings, Clerk Ritter; Utility Supervisor Sorenson; Alderperson Cummings and E. Butzine.
2. APPROVAL OF MEETING MINUTES – October 5, 2023 [A.Kuhl/Haseleu] VOICE VOTE: Motion carried.
3. CITIZEN INPUT / PUBLIC COMMENT - none
4. PROJECT OVERSIGHT & UPDATES
5. UNFINISHED BUSINESS
6. NEW BUSINESS
 - a. Discussion on Street Lamps, Tree Removal and Sidewalk Replacement on E Madison Street – informational only
7. FUTURE AGENDA ITEMS AND ANNOUNCEMENTS. –
8. ADJOURNMENT [A. Kuhl/Haseleu] VOICE VOTE: Motion carried. 6:47 pm

Jeanne Ritter
Clerk/Deputy Treasurer



136 North Monroe Street, Waterloo, Wisconsin 53594-1198
Phone (920) 478-3025
Fax (920) 478-2021

ORDINANCE #2024-05

**DEAD, DISEASED OR HAZARDOUS TREES ON PRIVATE PROPERTY
332-5 AND 332-7**

§ 332-5 Trespass on private land.

~~This chapter shall not give the Tree Committee authority to trespass on private land without the consent of the owner.~~

§332-7 Dead, diseased or hazardous trees on private property.

The City Forester or his/her designee shall investigate any tree, shrub, plant or plant part that is suspected to be public nuisance. Upon the discovery of any tree, shrub or plant which, by reason of its condition: interferes with the use of any public area; is infected with a plant disease; is infested with injurious insects or pests; is injurious to public improvements; endangers the life, health, safety or welfare of persons or property; the City Forester shall at once cause written notice to be served upon the owner of the property upon which such hazardous, diseased or infested tree, shrub or plant is situated, and the notice shall require such property owner to: 1) submit to the City of Waterloo an agreement with a tree removal company to eradicate, remove or otherwise control such condition within 30 days of specified notice, or 2) have the dead, diseased or hazardous tree, shrub or plant removed within 90 days of submitted bid to the City. If Violation of this section shall be subject to the penalties set forth in §332-6.

The provisions of §332-4 shall apply in addition to the penalties set forth in §332-6.

Adopted at a regular meeting of the Common Council on _____, 2024.

CITY OF WATERLOO

Signed: _____
Jenifer Quimby, Mayor

Attest: _____
Jeanne M. Ritter, Clerk/Deputy Treasurer

Date Adopted:

Date Published:



2023 Roadway Ratings

Sunday, December 17, 2023

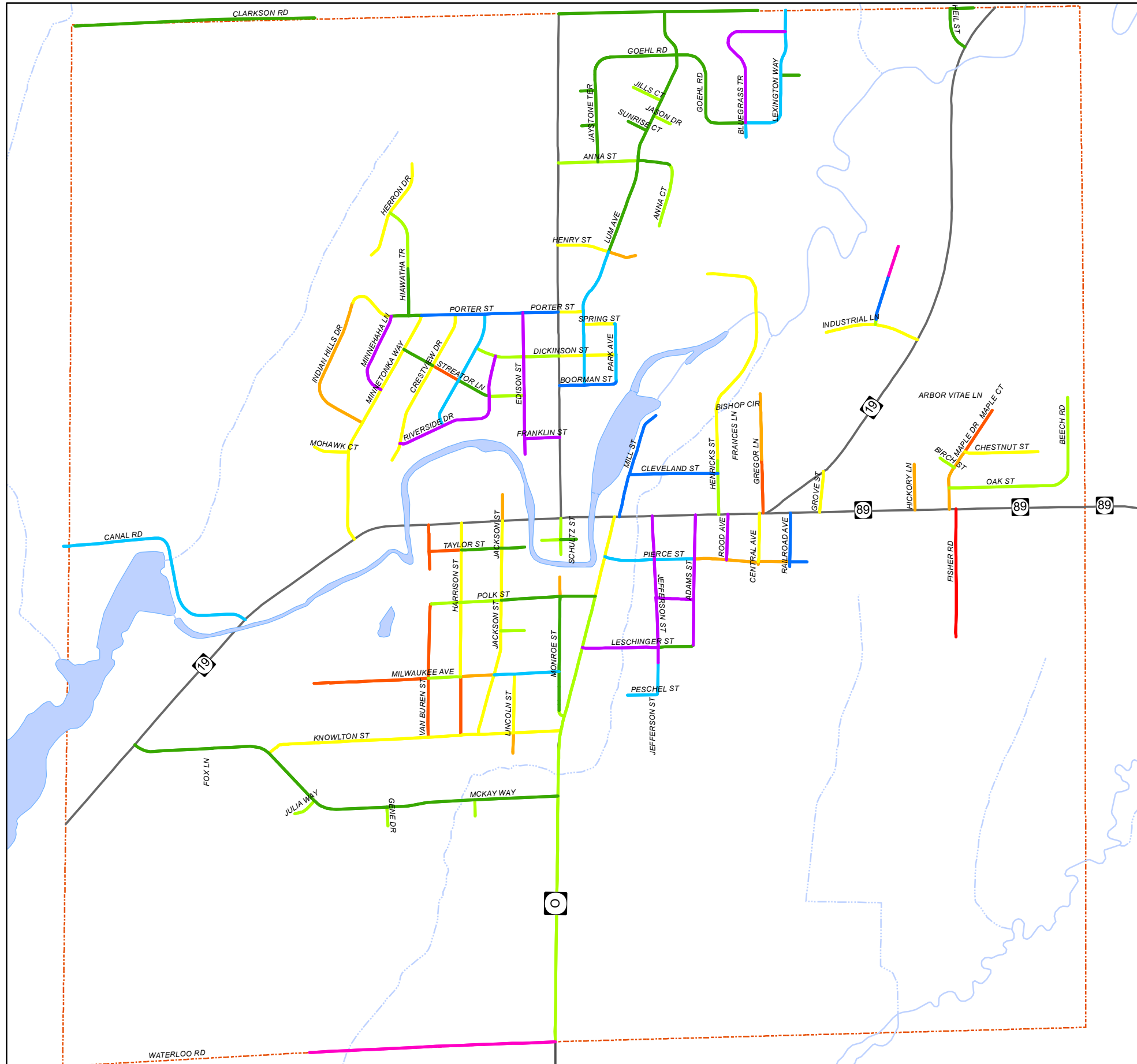

PASER Ratings

- 10 Excellent
- 9 Excellent
- 8 Very Good
- 7 Good
- 6 Good
- 5 Fair
- 4 Fair
- 3 Poor
- 2 Very Poor
- 1 Failed

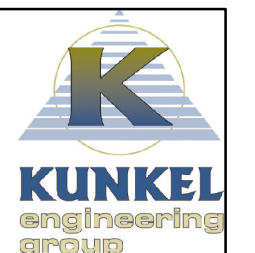
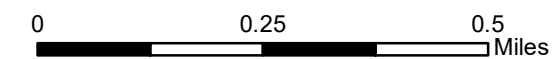



107 PARALLEL STREET
BEAVER DAM, WI 53916

1115 S. MAIN STREET
WEST BEND, WI 53095

920-356-9447
FAX 920-356-9454
KUNKELENGINEERING.COM

January 16, 2024

Jenifer Quimby, Mayor
City of Waterloo
163 North Monroe Street
Waterloo, Wisconsin 53594

Re: Engineering Services Proposal | 2024 City Hall Parking Lot Improvements

Dear Mayor,

Please consider this transmittal a formal proposal for Kunkel Engineering Group to provide Engineering Services to include design, construction related services and resident inspection in conjunction with the reconstruction of the parking lot and pedestrian areas at City Hall as well as sidewalk extensions on McKay Way and South Monroe Street.

It is understood that reconstruction is proposed for the parking lot located to the north and east of City Hall along with the pedestrian areas located to the south. Parking Lot reconstruction is to include removal of the existing impervious areas, evaluation of the base course, site grading to ensure positive drainage, placement of hot mix asphalt, pavement markings, beam guard and restoration of disturbed areas.

Further included with this project are two locations for sidewalk extensions. The first is located on the west side of McKay Way from 730 McKay way north approximately 150 feet, opposite Knowlton Street. The second along the west side of South Monroe Street between Knowlton Way and McKay Way for approximately 375 feet.

Kunkel Engineering Group proposes to provide the City of Waterloo the services as stated above in accordance with Attachment A, included with this transmittal. Please be advised that these figures are a “maximum not-to-exceed” fee for undertaking these work efforts. Our fees provide for services through December 2025, to ensure service through the final completion of the project.

Mayor, at your direction, work efforts will be initiated and completed as described within this proposal. Should you or the Common Council have any questions relative to this transmittal, please contact me at your earliest convenience. Again, we look forward to the opportunity to serve the City of Waterloo on this most important project.

Sincerely,

KUNKEL ENGINEERING GROUP



Mitchell Leisses
Office/Project Manager

X

City of Waterloo, WI

Date

Attachment A

WORK SCOPE

City of Waterloo
2024 City Hall Parking Lot Improvements

Design Services

- A. Field Data Acquisition:
 - 1. Review Existing Reports and Records
 - 2. As-built Street and Sections
 - 3. Location Survey
 - 4. Utility Location
 - a. Sanitary Sewer
 - b. Water Main
 - c. Storm Sewer
 - d. Electric/Gas/Telephone/Cable

- B. Design Phase:
 - 1. Prepare Plan and Profile Base Sheets
 - 2. Final Plan Preparation
 - a. Project Plans
 - b. Construction Details
 - c. Erosion Control

- C. Construction Documents and Specifications
 - 1. Bidding Documents
 - 2. General Conditions
 - 3. Special Provisions
 - 4. Document Compilation
 - 5. Plan Quantity Takeoff

- D. Regulatory Agency Compliance:
 - 1. Solicit WDNR Approval
 - a. Water Resources Application for Project Permits (WRAPP)
 - b. Chapter 30 Permit (if needed)

- E. Prepare Final Construction Cost Estimate

- F. Miscellaneous:
 - 1. Meet with private utilities, as necessary, to resolve conflicts existing and proposed.
 - 2. Meet with City officials, staff, and consultants to secure approvals and facilitate financing (if required).

Cost of Design Services:

Parking Lot Improvements and Sidewalk Extensions

\$38,000.00

Attachment A

Construction Related Services

- A. Parking Lot Improvements:
 - 1. Construction Staking
 - 2. Residential Inspection
 - 3. As-built Records

- B. Pedestrian Area Improvements:
 - 1. Construction Staking
 - 2. Residential Inspection
 - 3. As-built Records

- C. Sidewalk Extensions:
 - 1. Construction Staking
 - 2. Residential Inspection
 - 3. As-built Records

Cost of Construction Related Services:

Parking Lot Improvements and Sidewalk Extensions \$34,628.00

Cost of Services Summary

Kunkel Engineering Group proposes to perform the tasks as presented and enumerated within the work scope for a maximum, not-to-exceed cost of **\$76,398.00**. A summary of the cost to undertake the tasks as delineated is as follows:

2024 City Hall Parking Lot Improvements Recapitulation

| | |
|---------------------------------------|--------------------|
| Design Services: | \$38,000.00 |
| <u>Construction Related Services:</u> | <u>\$34,628.00</u> |
| Total Cost | \$72,628.00 |

Notes:

- 1. Services described herein are intended to be comprehensive. Should the City of Waterloo require more or fewer services than described, cost and adjustments will be negotiated.

CITY OF WATERLOO, WISCONSIN

2024 CITY HALL PARKING LOT RECONSTRUCTION

UTILITIES

GAS
 WE ENERGIES
 PHONE (414) 751-7273
 CONTACT: ABIGAIL TANNER
 EMAIL: abigail.tanner@we-energies.com
 EMAIL: we-utility-relocations@we-energies.com

MUNICIPAL WATER
 WATERLOO UTILITIES
 575 COMMERCIAL AVE.
 WATERLOO, WI 53594
 PHONE 920-478-2260
 CONTACT: BARRY SORENSON
 EMAIL bsorensen@wppienergy.org

DEPT OF PUBLIC WORKS AND SEWER UTILITY
 211 HENDRIX ST
 WATERLOO, WI 53594
 PHONE 920-478-9797
 CONTACT: CHAD YERGES
 Email dpw@waterloo.wi.us

TELEPHONE
 FRONTIER COMMUNICATIONS
 100 COMMUNICATIONS DRIVE
 SUN PRAIRIE, WI 53590
 PHONE 608-837-1605
 CONTACT: DANA GILLET
 EMAIL: dana.gillett@ftr.com

CABLE TELEVISION
 CHARTER COMMUNICATIONS
 2701 DANIELS STREET
 MADISON, WI 53718
 PHONE 920-349-3202 X72523
 CONTACT: RON FRASE
 EMAIL: RON.FRASE@CHARTER.COM

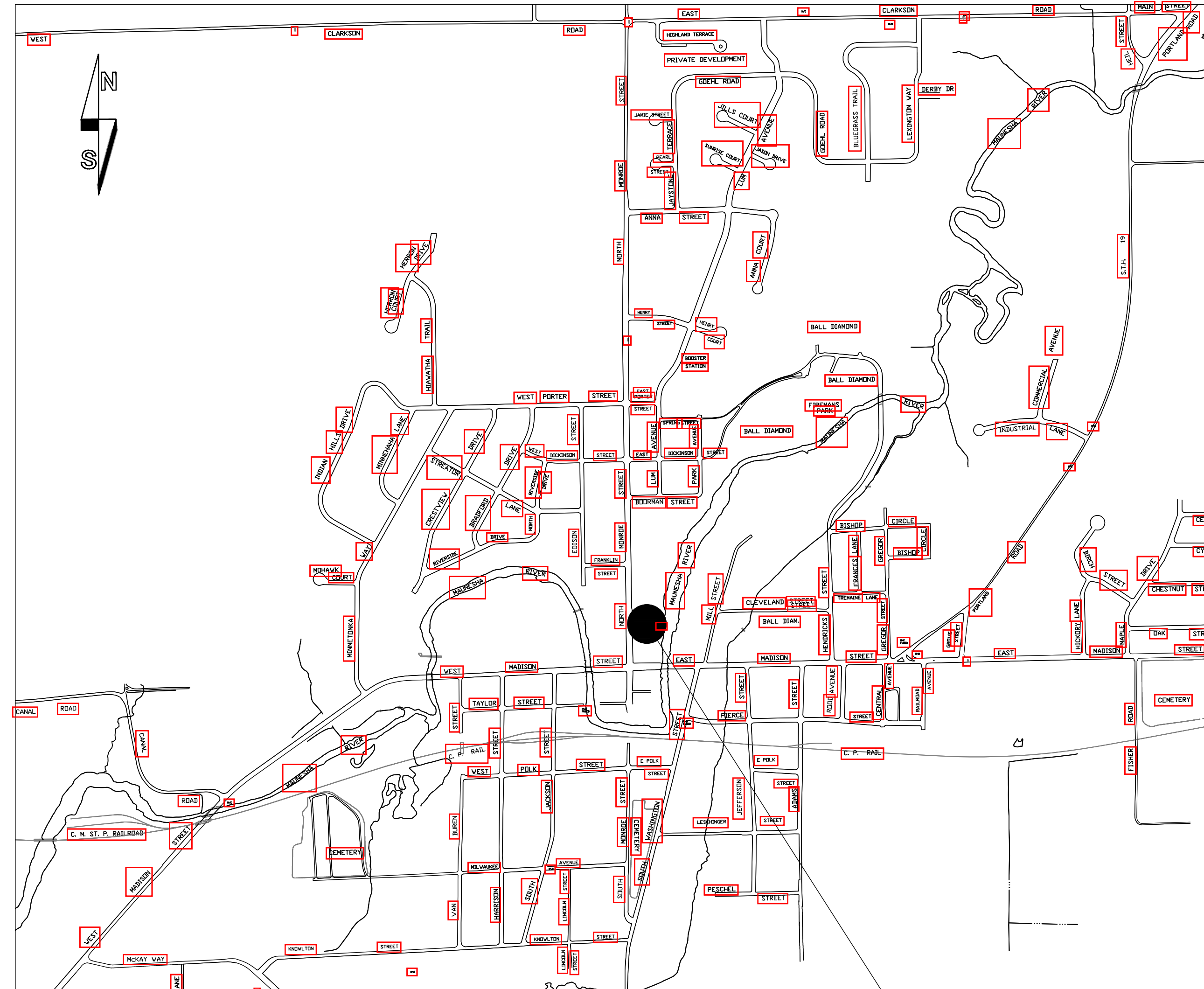

SHEET INDEX

- 1 COVER PAGE
- 2 DEMOLITION PLAN
- 3 SITE AND EROSION CONTROL PLAN
- 4 GRADING AND DRAINAGE PLAN
- 5 EROSION CONTROL DETAILS
- 6 CONSTRUCTION DETAILS

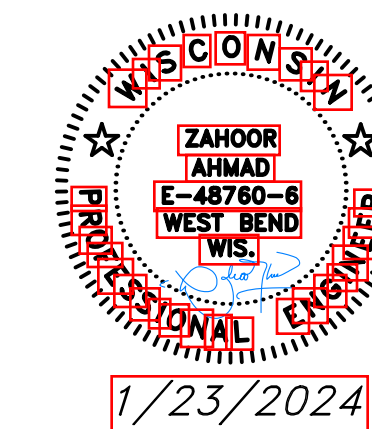

PROJECT LOCATION

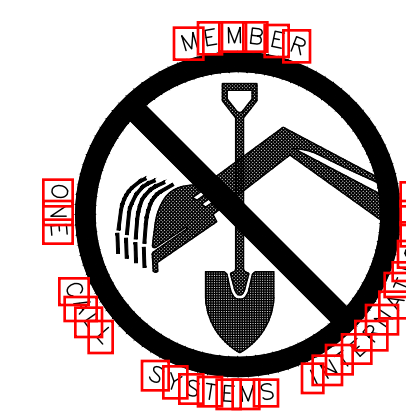
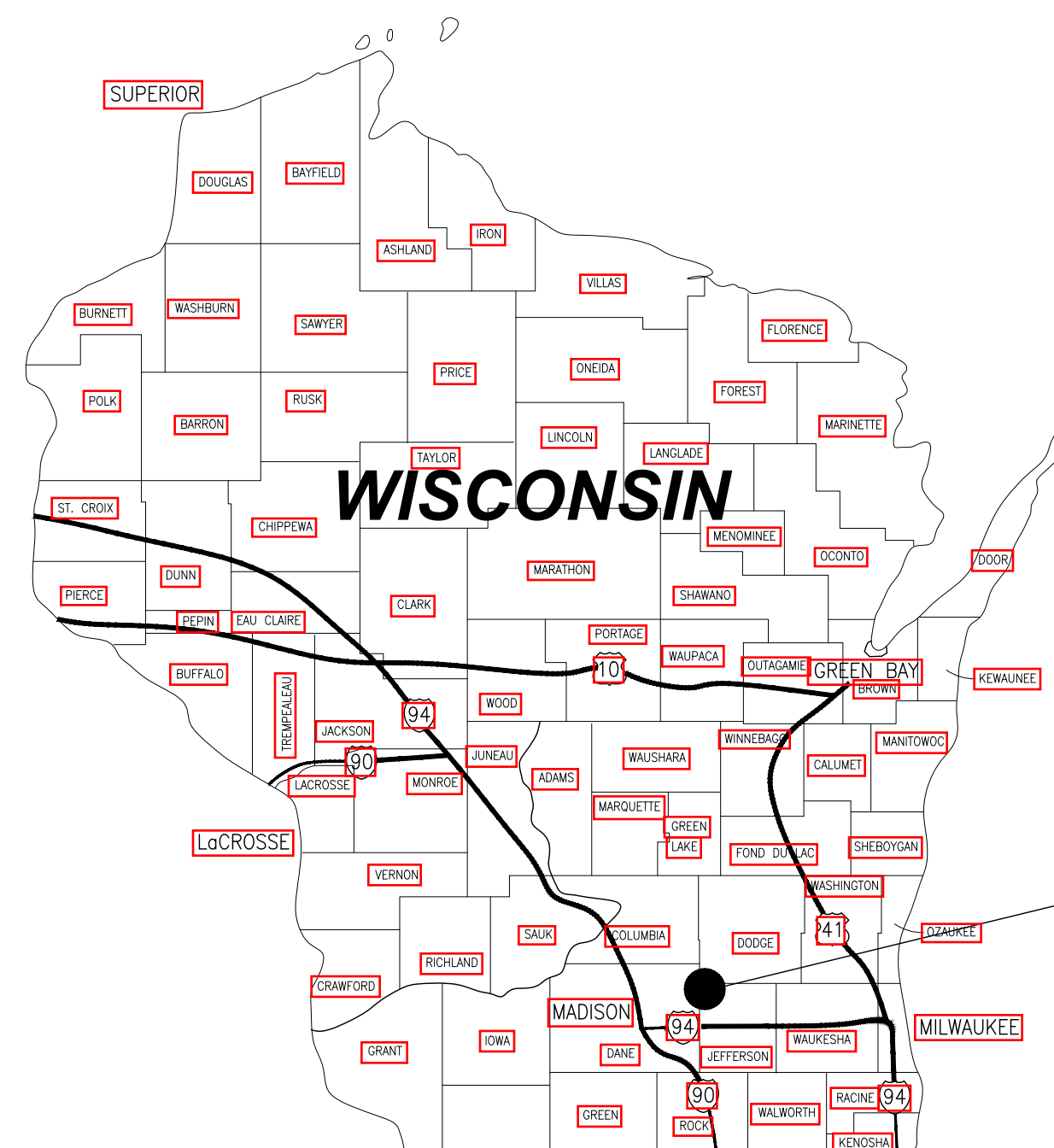

TO OBTAIN LOCATION OF PARTICIPANTS' UNDERGROUND FACILITIES BEFORE YOU DIG IN WISCONSIN

CALL DIGGERS HOTLINE

811

TOLL FREE 1-800-242-8511

EMERGENCY # ONLY 1-877-500-9592

TDD (FOR HEARING IMPAIRED) 1-800-542-2289

WWW.DiggersHotline.com

WISCONSIN STATUTE 182.0175 (1974)
 REQUIRES MINIMUM OF 3 WORK DAYS
 NOTICE BEFORE YOU EXCAVATE.

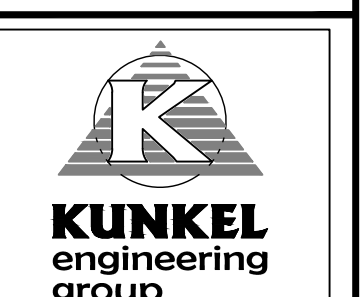

1115 South Main Street
 West Bend, WI 53094
 (920) 356-9447
 Fax (920) 356-9454

NORTH MONROE STREET

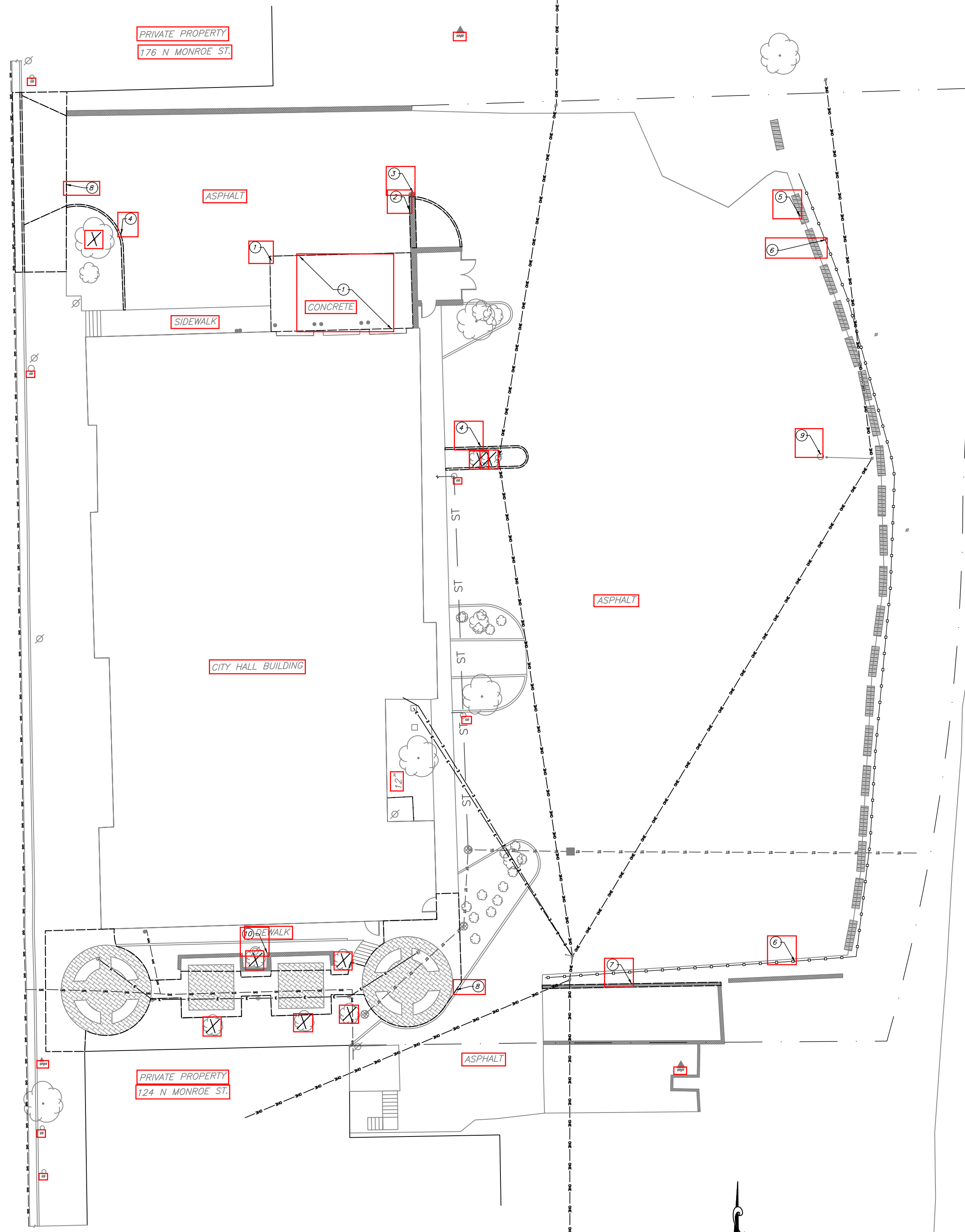

- # PLAN CALLOUTS:**
1. REMOVE EXISTING 6" CONCRETE PAD TO THE LIMITS SHOWN.
 2. REMOVE EXISTING BRICK WALL TO THE LIMITS SHOWN.
 3. REMOVE THE BOLLARDS.
 4. REMOVE EXISTING CURB TO THE LIMITS AS SHOWN.
 5. REMOVE AND SALVAGE THE EXISTING CONCRETE BLOCKS TO THE LOCATION AS REQUESTED BY CITY'S PUBLIC WORKS DEPARTMENT.
 6. REMOVE THE EXISTING GUARD RAIL
 7. REMOVE THE EXISTING CONCRETE RETAINING WALL TO A DEPTH APPROPRIATE FOR PLACING TOP SOIL FOR RESTORATION.
 8. REMOVE CONCRETE SIDEWALK TO THE LIMITS SHOWN.
 9. REMOVE THE EXISTING STEEL POLE.
 10. REMOVE THE EXISTING RETAINING WALL WITH FOUNDATION

LEGEND:

- PARTIAL DEMOLITION LIMITS
- EXISTING GUARD RAIL
- ▨ EXISTING CONCRETE BLOCKS
- STEEL POLE
- ⊗ EXISTING UTILITY/LIGHT/FLAG POLES
- EXISTING BOLLARDS
- ▩ EXISTING RETAINING WALLS
- GUY WIRE
- ▲ CONTROL POINTS
- ⊗ TREE REMOVAL



KUNKEL
engineering
group

107 Parallel Street
Beaver Dam, WI 53916
(920)356-9447
Fax (920)356-9454

| | | | | | |
|--------------|----------|-----------|------------------|----------|-----------|
| DESIGNED BY: | DATE: | INITIALS: | DRAWN BY: | DATE: | INITIALS: |
| DRAWN BY: | 01-22-24 | KG | 1st REVISION BY: | 01-22-24 | KG |
| CHECKED BY: | 01-22-24 | ZA | 2nd REVISION BY: | 01-23-24 | ZA |
| APPROVED BY: | 01-23-24 | ZA | ASBUILT BY: | 01-23-24 | ZA |

NOTE:
1. CERTAIN UTILITIES AND/OR STRUCTURES BOTH ABOVE AND BELOW GROUND HAVE BEEN LOCATED ON THE PLANS. THESE LOCATIONS ARE APPROXIMATE. THE CONTRACTOR SHALL VERIFY THE LOCATION AND DEPTH OF ALL UTILITIES AND/OR STRUCTURES, WHETHER SHOWN ON THE PLANS OR NOT, SHALL BE ASSUMED TO BE A PART OF THE CONTRACT. RIGHT OF WAY LINES OR PROPERTY LINES SHOWN ON THESE PLANS ARE ONLY GENERAL APPROXIMATIONS OF BOUNDARIES AND ARE NOT INTENDED TO BE USED BY ANY NON-CITY PERSONNEL FOR ANY PURPOSE WITHOUT FIRST CONSULTING WITH THE CITY SUPERVISOR OR THE PROJECT ENGINEER OR KUNKEL ENGINEERING GROUP.

City of Waterloo, WI
2024 City Hall Parking Lot Reconstruction
Demolition Plan

SCALE AS SHOWN:

ENGINEER PROJ NO:
KU23.1053.00

OWNER PROJ NO:

SHEET NUMBER:
2 of 6

STANDARD EROSION CONTROL PROVISIONS

GENERAL NOTES FOR CONSTRUCTION EROSION CONTROL:

- REFER TO WDNR'S STORMWATER WEB PAGE OF TECHNICAL STANDARDS @ [HTTP://DNR.WI.GOV/ORG/WATER/WM/NPS/STORMWATER/TECHSTDS.HTM#CONSTRUCTION](http://DNR.WI.GOV/ORG/WATER/WM/NPS/STORMWATER/TECHSTDS.HTM#CONSTRUCTION)
- CONSTRUCT AND MAINTAIN ALL EROSION AND SEDIMENT CONTROL MEASURES IN ACCORDANCE WITH THE WDNR'S STORMWATER WEB PAGE OF TECHNICAL STANDARDS @ [HTTP://DNR.WI.GOV/ORG/WATER/WM/NPS/STORMWATER/TECHSTDS.HTM#CONSTRUCTION](http://DNR.WI.GOV/ORG/WATER/WM/NPS/STORMWATER/TECHSTDS.HTM#CONSTRUCTION)
- INSTALL SEDIMENT CONTROL MEASURES PRIOR TO ANY GRADING OR DISTURBANCE OF EXISTING SURFACE MATERIAL. ADJUST ALL SEDIMENT CONTROL MEASURES TO MEET FIELD CONDITIONS AT THE TIME OF CONSTRUCTION.
- PROVIDE WEEKLY INSPECTION AND MAINTENANCE OF ALL SEDIMENT CONTROL STRUCTURES TO ENSURE INTENDED PURPOSE IS ACCOMPLISHED. MAINTAIN DOCUMENTATION OF INSPECTIONS PER THE PROJECT SPECIAL PROVISIONS. SEDIMENT CONTROL MEASURES ARE TO BE IN WORKING CONDITION AT THE END OF EACH WORKING DAY.
- IN ADDITION TO WEEKLY INSPECTIONS, INSPECT SEDIMENT CONTROL STRUCTURES FOR INTEGRITY AFTER ANY RAINFALL OF 1/2" OR GREATER AND CORRECT ANY DAMAGED STRUCTURES.
- DO NOT REMOVE SEDIMENT CONTROL MEASURES UNTIL THE AREAS SERVED HAVE ESTABLISHED VEGETATIVE COVER.
- COLLECT TRACKED SOIL FROM PAVED ROADS LOCATED NEAR THE CONSTRUCTION SITE. ALL STREETS SHALL BE SWEEPED AND CLEARED OF ALL DIRT AND DEBRIS DAILY.
- WHEN DISCHARGING TRENCH WATER REFER TO WDNR TECHNICAL STANDARD 1061 FOR DE-WATERING IN ORDER TO PROPERLY FILTER WATER IN A SETTLING BASIN OR FILTERING DEVICE PRIOR TO RELEASE INTO A INTO A STORM SEWER OR STREAM.
- PROTECT STORM SEWER SECTION BASINS FROM RUN-OFF WITH FABRIC PER WDNR TECH STD 1060.
- ALL LAND DISTURBANCE AND STABILIZATION FOR THIS PROJECT WILL OCCUR BETWEEN APRIL 15TH AND SEPTEMBER 15TH. WARM SEASON SEEDING CAN BE USED DURING THIS TIME PERIOD. SHOULD SEEDING NEED TO BE COMPLETED AFTER NOVEMBER 15TH, A DORMANT SEED MUST BE USED. ALL SEEDING CONSTRUCTION SHALL CONFORM TO WDNR CONSERVATION PRACTICE STANDARD 1059.

CONFORM TO APPLICABLE WDNR TECHNICAL STANDARDS

- 1056 SILT FENCE
- 1057 TRACKOUT CONTROL PRACTICES
- 1060 INLET PROTECTION
- 1068 DUST CONTROL

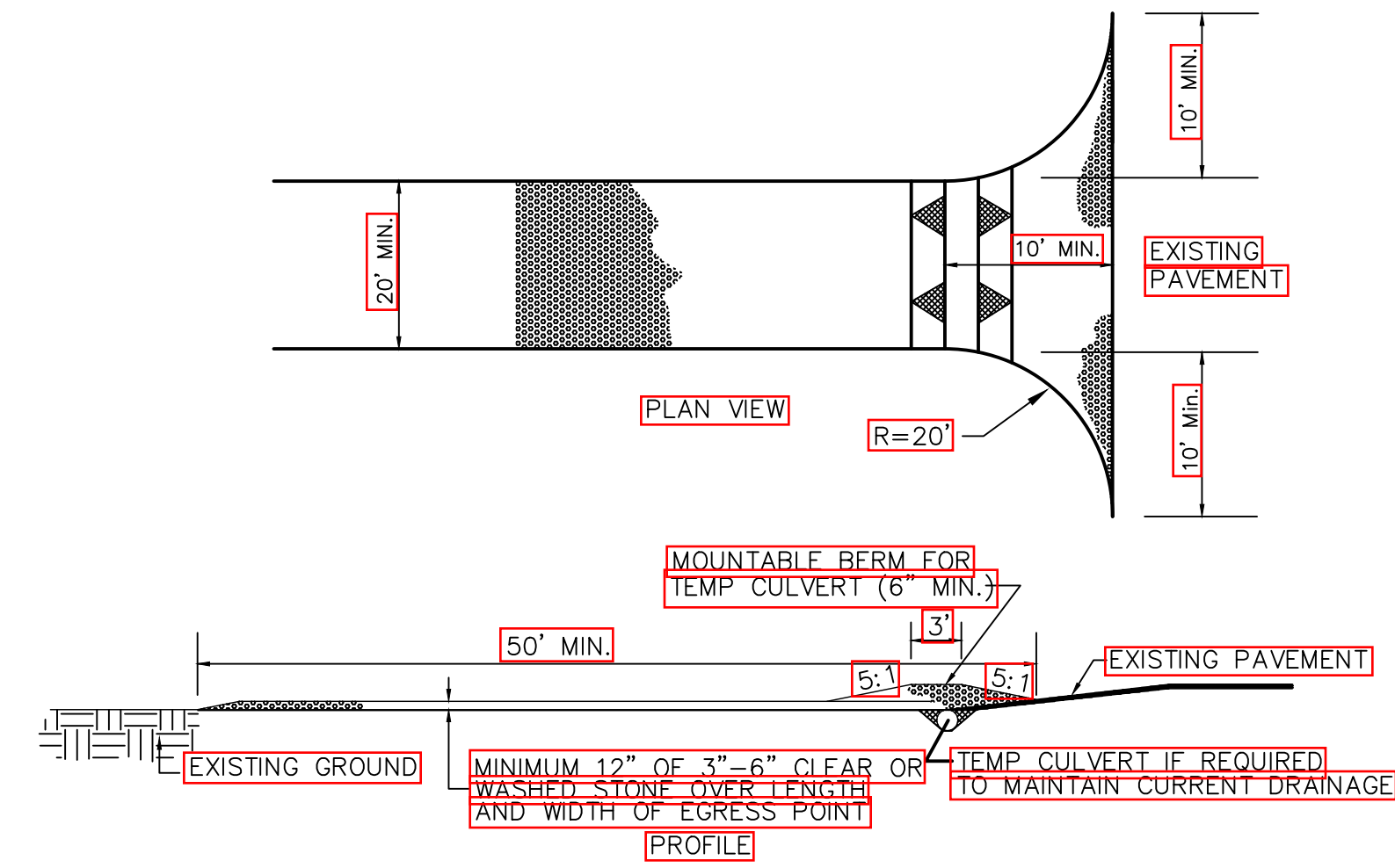

- LOCATION - A TRACKING PAD SHALL BE LOCATED AT EVERY POINT WHERE CONSTRUCTION TRAFFIC ENTERS OR LEAVES A CONSTRUCTION SITE. VEHICLES LEAVING THE SITE MUST TRAVEL OVER THE ENTIRE LENGTH OF THE STABILIZED CONSTRUCTION ENTRANCE.
- SURFACE WATER - ALL SURFACE WATER FLOWING TO OR DIVERTED TOWARD CONSTRUCTION ENTRANCES SHALL BE PIPED THROUGH THE ENTRANCE. MAINTAINING POSITIVE DRAINAGE. PIPE INSTALLED THROUGH THE STABILIZED CONSTRUCTION ENTRANCE SHALL BE PROTECTED WITH A MOUNTABLE BERM WITH 5:1 SLOPES AND MINIMUM OF 6" OF STONE OVER THE PIPE. TO BE SIZED ACCORDING TO THE DRAINAGE. 8" MINIMUM WILL BE REQUIRED.
- MAINTENANCE - TRACKING PAD SHALL BE INSPECTED DAILY AND REPAIRED OR REPLACED IMMEDIATELY.
- REMOVAL - SITE STABILIZED/SEEDED/PAVED AS PER SPECIAL PROVISIONS.

TRACKING PAD / STABILIZED CONSTRUCTION ENTRANCE

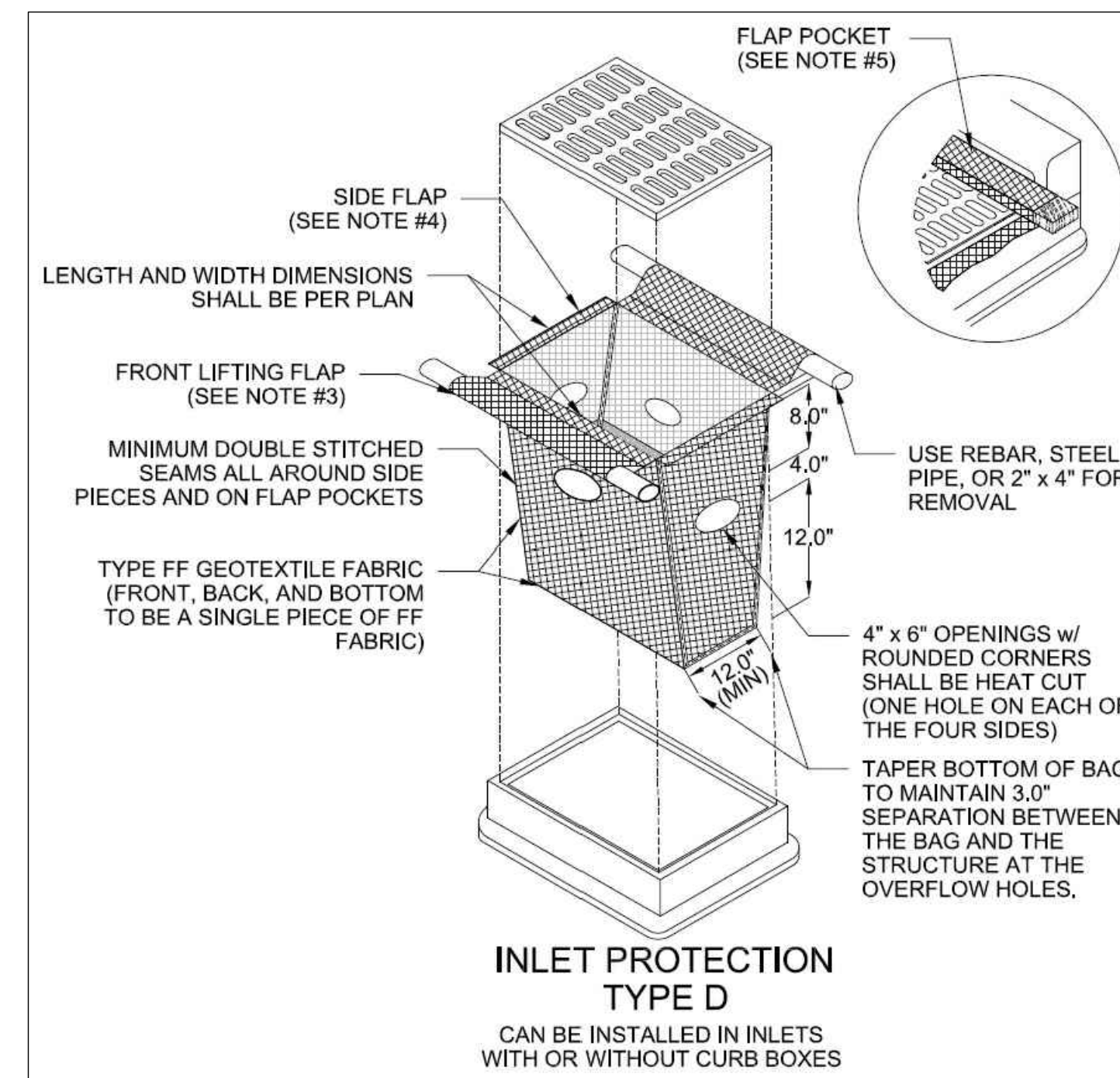

INLET PROTECTION TYPE D

INLET PROTECTION TYPE D SHALL BE INSTALLED IN ACCORDANCE WITH WDNR TECHNICAL STANDARDS 1060. INLET PROTECTION IS TO BE INSTALLED ON ALL EXISTING AND INSTALLED INLETS IN THE PROJECT LIMITS AS SHOWN ON THE PAVING PLANS OR AS DIRECTED BY OWNER/ENGINEER. INLET PROTECTION FOR NEW OR REPLACEMENT INLETS IS TO BE INSTALLED AS THEY ARE INSTALLED.

NOTES:

- TAPER BOTTOM OF BAG TO MAINTAIN THREE INCHES OF CLEARANCE BETWEEN BAG AND STRUCTURE, MEASURED FROM THE BOTTOM OF THE OVERFLOW OPENINGS TO THE STRUCTURE WALL.
- GEOTEXTILE FABRIC TYPE FF FOR FLAPS, TOP AND BOTTOM OF OUTSIDE OF FILTER BAG.
- FRONT LIFTING FLAP IS TO BE USED WHEN REMOVING AND MAINTAINING FILTER BAG
- SIDE FLAPS SHALL BE A MAXIMUM OF TWO INCHES LONG, FOLD THE FABRIC OVER AND REINFORCE WITH MULTIPLE STITCHES.
- FLAP POCKETS SHALL BE LARGE ENOUGH TO ACCEPT 2"x4". THE REBAR, STEEL PIPE, OR WOOD SHALL BE INSTALLED IN THE REAR FLAP AND SHALL NOT BLOCK THE TOP HALF OF THE CURB FACE OPENING.

MAINTENANCE NOTES:

- WHEN REMOVING OR MAINTAINING INLET PROTECTION, CARE SHALL BE TAKEN SO THAT THE SEDIMENT TRAPPED IN THE FABRIC DOES NOT FALL INTO THE STRUCTURE. MATERIAL THAT HAS FALLEN INTO THE INLET SHALL BE IMMEDIATELY REMOVED.

SILT FENCE
SILT FENCE MUST BE INSTALLED PER SHOWN EROSION CONTROL DETAILS WHERE SHOWN ON THE PLANS.

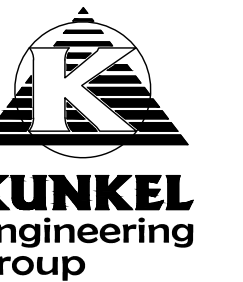
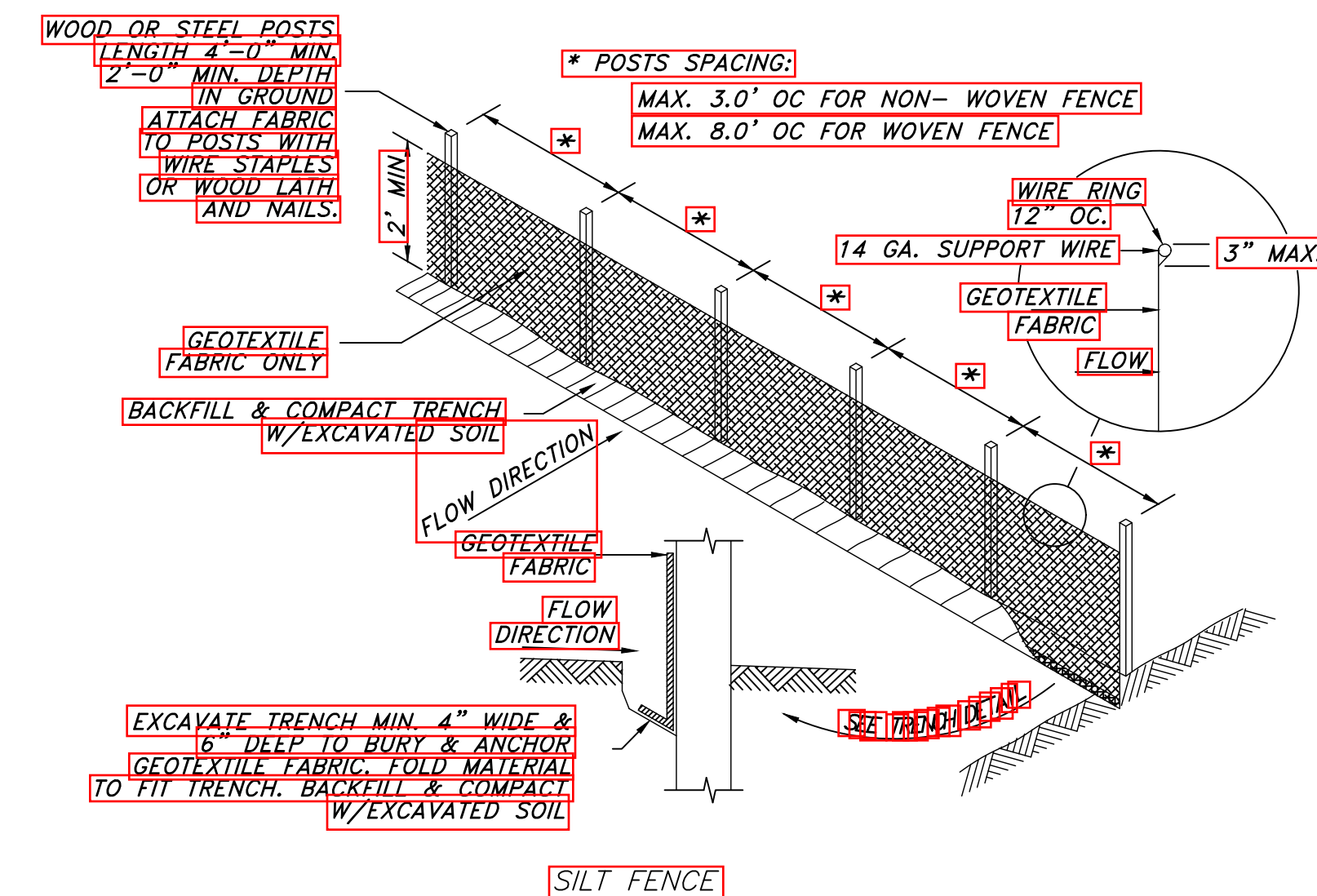

1107 Parallel Street
Beaver Dam, WI 53916
(920) 356-9447
Fax (920) 356-9454

| INITIALS | DATE | DESIGNED BY: | DATE |
|----------|------|--------------|----------|
| ### | ### | KG | 01-15-24 |
| ### | ### | KG | 01-15-24 |
| ### | ### | ZA | 01-15-24 |
| ### | ### | ZA | 01-15-24 |

1ST REVISION BY: 1ST REVISION BY: 2ND REVISION BY: 2ND REVISION BY: ASBUILT BY: ASBUILT BY:

NOTE:
1. CERTAIN UTILITIES AND/OR STRUCTURES BOTH ABOVE AND BELOW GROUND HAVE BEEN LOCATED ON THE PLANS. THESE LOCATIONS SHALL NOT BE TAKEN AS CONCLUSIVE. VERIFICATION TO THE SATISFACTION OF THE CONTRACTOR OF THE EXACT LOCATION AND DEPTH OF ALL UTILITIES AND/OR STRUCTURES, WHEN SHOWN ON THE PLANS OR NOT, SHALL BE ASSIGNED TO BE A PART OF THE CONTRACT.
2. ANY STREET RIGHT OF WAY LINES OR PROPERTY LINES SHOWN ON THESE PLANS ARE ONLY GENERAL APPROXIMATIONS OF SAID LINES. THE CONTRACTOR SHALL VERIFY THE EXACT LOCATION AND DEPTH OF ALL UTILITIES AND/OR STRUCTURES, WHEN SHOWN ON THE PLANS OR NOT, SHALL BE ASSIGNED TO BE A PART OF THE CONTRACT. CONSULT WITH THE CITY SURVEYOR OR THE PROJECT ENGINEER OR KUNKEL ENGINEERING GROUP.

NORTH MONROE STREET

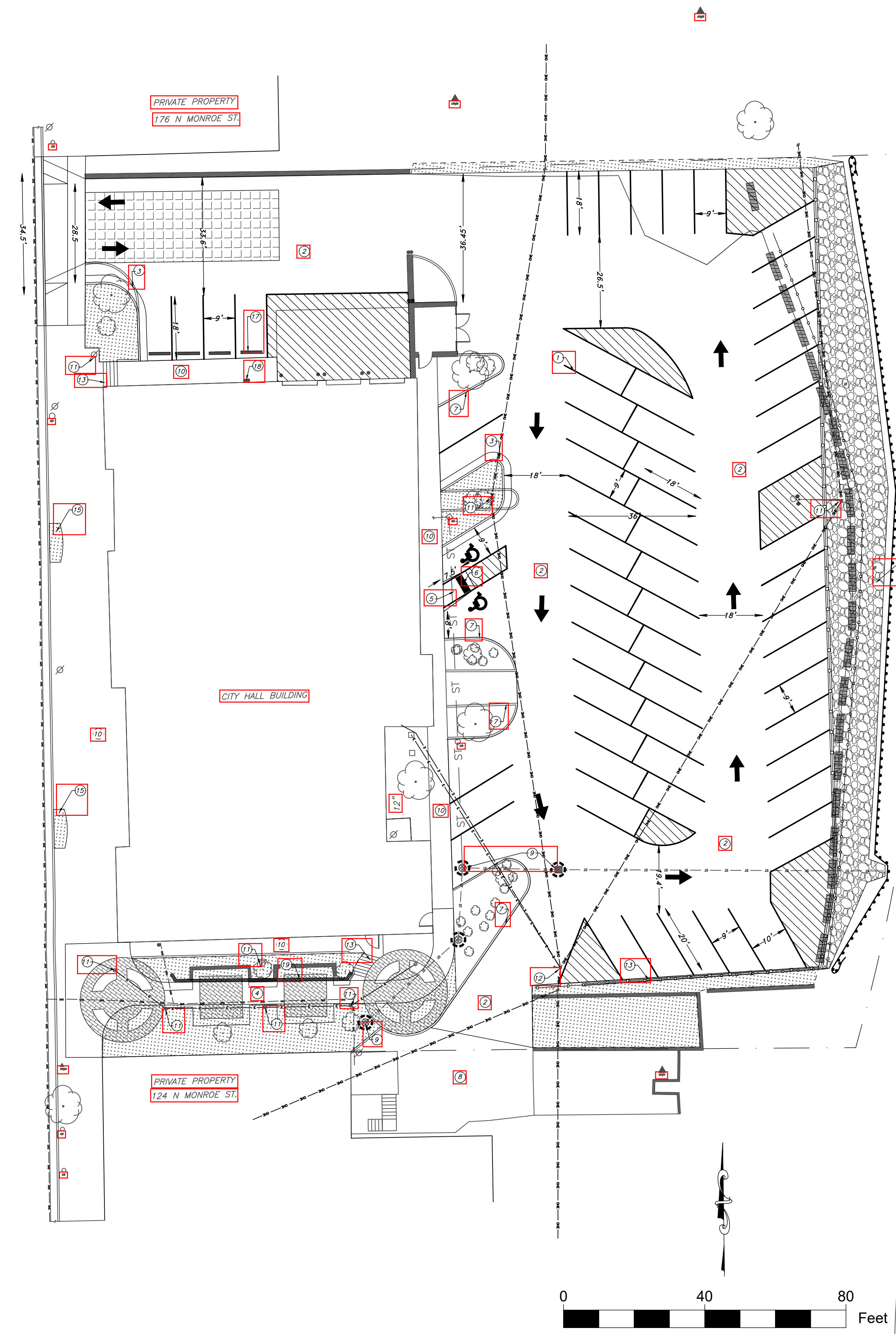

- # PLAN CALLOUTS:**
1. PAVEMENT MARKING – 4" WHITE LATEX, TYP.
 2. PROPOSED 4-INCH H.M.A PAVEMENT WITH 8" BASE COURSE
 3. REMOVE AND REPLACE 30" CURB & GUTTER
 4. PROPOSED 4" CONC. SIDEWALK
 5. REMOVE AND REPLACE 4" CONC. SIDEWALK RAMP
 6. PROPOSED 2'x5' DETECTABLE WARNING FIELD – ADA COMPLIANT
 7. EXIST. CURB & GUTTER, REMAINS
 8. EXIST. H.M.A PAVEMENT, REMAINS
 9. ADJUST EXIST. INLET FRAME & GRATE
 10. EXISTING SIDEWALK REMAINS
 11. EXISTING LIGHT POLE, REMAINS
 12. EXISTING UTILITY POLE. REMAINS
 13. EXISTING STEPS REMAINS
 14. REMOVE AND REPLACE GUARDRAIL – STEEL PLATE BEAM GUARD TYPE 2 AS PER WISDOT STD.SPEC.614.
 15. REMOVE 4" CONCRETE SIDEWALK AND PLACE TOP SOIL AND SEEDS.
 16. PROPOSED 4200 SQ.F OF MEDIUM SIZE RIPRAP AS PER WISDOT STD.SPEC.606.
 17. PROPOSED 7' CONCRETE WHEEL STOP.
 18. PAINT THE EXISTING BOLLARDS YELLOW.
 19. OPPOSED MODULAR BLOCK RETAINING WALL.
- NUMBER OF EXISTING STALLS: 49
NUMBER OF PROPOSED STALLS: 62

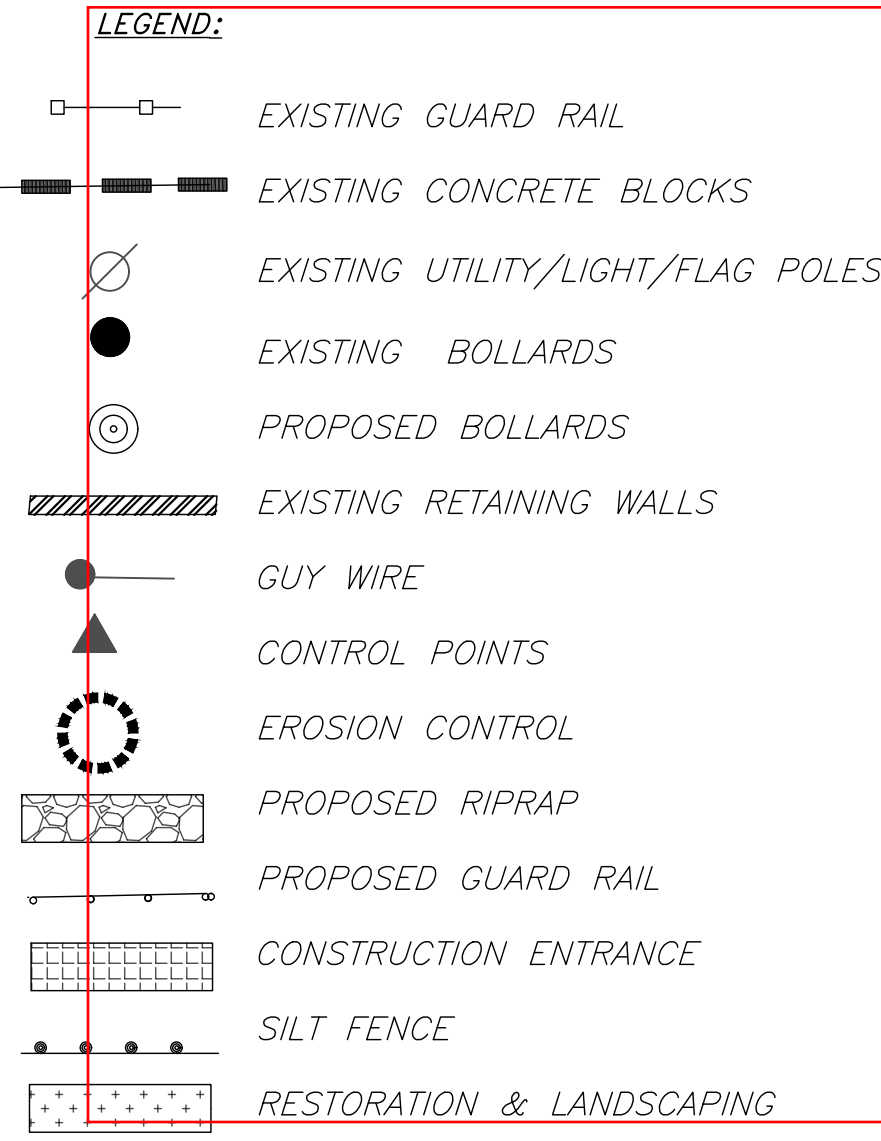

KUNKEL
engineering
group

107 Parallel Street
Beaver Dam, WI 53916
(920)356-9447
Fax (920)356-9454

| INITIALS | DATE | 1st REVISION BY: | 2nd REVISION BY: | ASBUILT BY: |
|----------|----------|------------------|------------------|-------------|
| KG | 01-22-24 | KG | 01-22-24 | ZA |
| KG | 01-22-24 | KG | 01-22-24 | ZA |
| KG | 01-22-24 | KG | 01-22-24 | ZA |
| KG | 01-22-24 | KG | 01-22-24 | ZA |

NOTE:
1. CERTAIN UTILITY AND/OR STRUCTURES BOTH ABOVE AND BELOW GROUND HAVE BEEN LOCATED ON THE PLANS. THESE LOCATIONS SHALL NOT BE TAKEN AS CONCLUSIVE. VERIFICATION TO THE SATISFACTION OF THE CONTRACTOR OF THE EXACT LOCATION AND DEPTH OF ALL UTILITIES SHALL BE THE RESPONSIBILITY OF THE CONTRACTOR. THE CONTRACTOR SHALL BE RESPONSIBLE FOR OBTAINING ALL NECESSARY PERMITS AND APPROVALS TO BE OBTAINED FROM THE CITY OF WATERLOO. THESE PERMITS AND APPROVALS SHALL BE OBTAINED BEFORE ANY CONSTRUCTION BEGINS. FOR ANY PURPOSE WITHOUT FIRST CONSULTING WITH THE CITY SURVEYOR OR THE PROJECT ENGINEER OR KUNKEL ENGINEERING GROUP.

City of Waterloo, WI
2024 City Hall Parking Lot Reconstruction
Site and Erosion Control Plan

SCALE AS SHOWN:

ENGINEER PROJ NO:
KU23.1053.00

OWNER PROJ NO:

SHEET NUMBER:
3 of 6

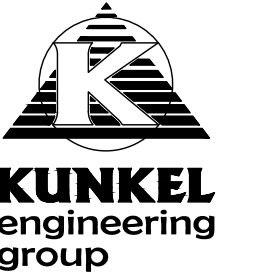

107 Parallel Street
 Beaver Dam, WI 53916
 (920)356-9447
 Fax (920)356-9454

INITIALS DATE

DESIGNED BY: .KG
 DRAWN BY: .KG
 CHECKED BY: ZA
 APPROVED BY: ZA

DATE
 01-22-24
 01-22-24
 01-23-24
 01-23-24

1st REVISION BY: ###
 2nd REVISION BY: ###
 ASBUILT BY: ###

NOTE:
 1. CERTAIN UTILITIES AND/OR STRUCTURES BOTH ABOVE AND BELOW GROUND HAVE BEEN LOCATED ON THE PLANS. THESE LOCATIONS ARE BASED ON RECORD DRAWINGS AND FIELD SURVEY. THE LOCATION OF ALL UTILITIES AND/OR STRUCTURES, WHETHER SHOWN ON THESE PLANS OR NOT, SHALL BE ASSUMED TO BE A PART OF THE CONTRACT. RIGHT OF WAY LINES OR PROPERTY LINES SHOWN ON THESE PLANS ARE ONLY GENERAL APPROXIMATIONS OF SAID LINES AND ARE NOT INTENDED TO BE USED BY ANY NON-CITY PERSONNEL FOR ANY PURPOSE WITHOUT FIRST CONSULTING WITH THE CITY SURVEYOR OR THE PROJECT ENGINEER OR KUNKEL ENGINEERING GROUP.

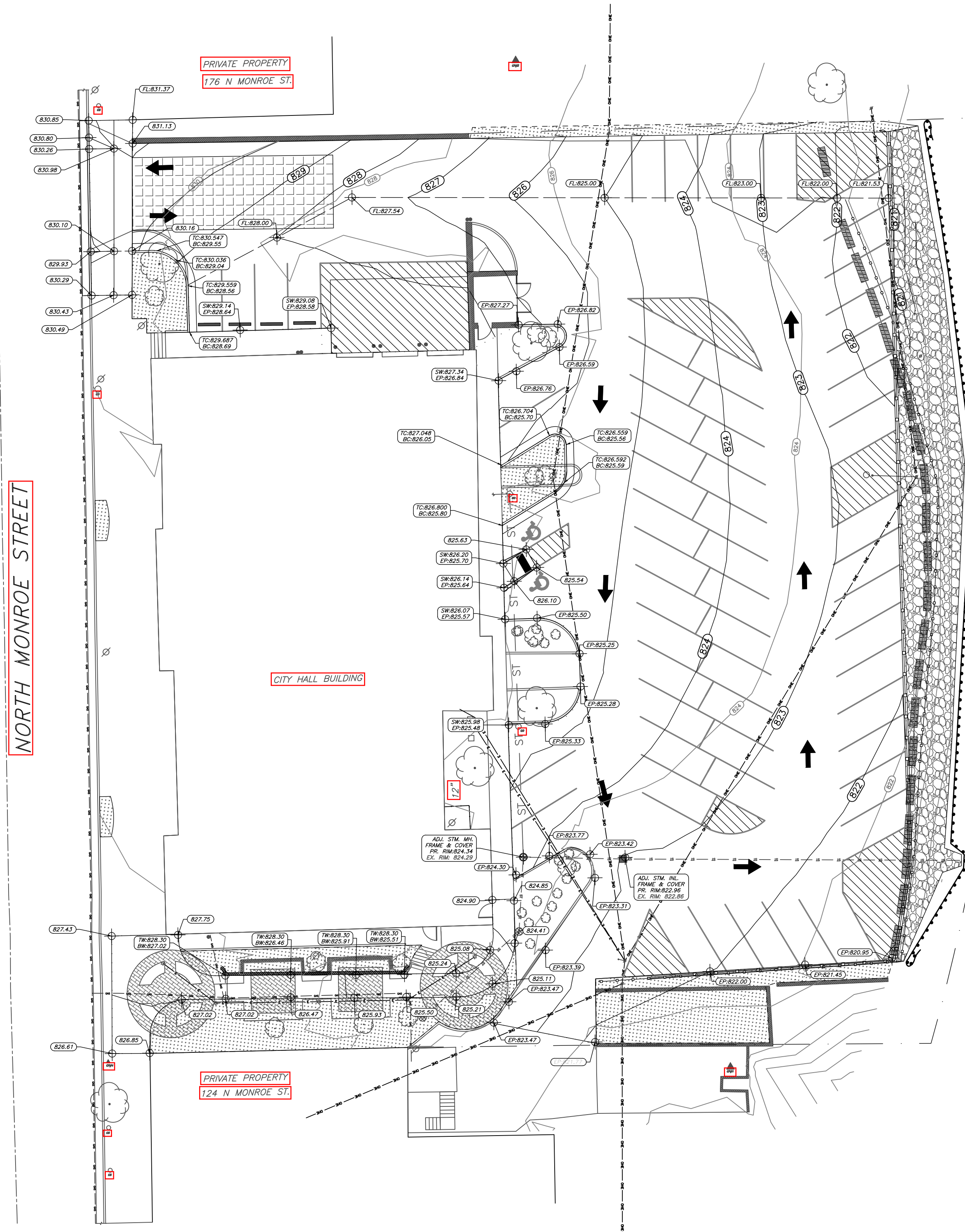

LEGEND:

| | |
|-----------|-------------------------------|
| 940.00 | PROP. SPOT GRADE |
| BC:940.00 | PROP. BOT. OF CURB |
| TC:940.00 | PROP. TOP OF CURB |
| FL:940.00 | PROP. FLOW LINE |
| 940.00 | EXIST. CONTOUR |
| 940.00 | PROP. CONTOUR (0.5') |
| --- | DISTURBANCE LIMITS (0.65 AC.) |

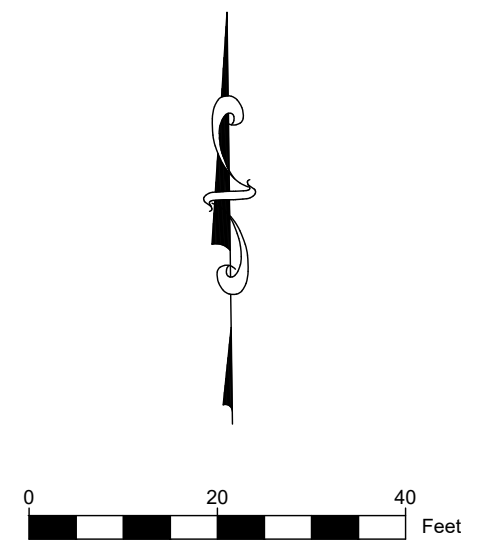

City of Waterloo, WI
 2024 City Hall Parking Lot Reconstruction
 Drainage and Grading Plan

SCALE AS SHOWN:
 ENGINEER PROJ NO:
 KU23.1053.00
 OWNER PROJ NO:
 SHEET NUMBER:
 4 of 6

STANDARD EROSION CONTROL PROVISIONS

General Notes for Construction Erosion Control:

1. Refer to WDNR's Stormwater web page of technical standards @ <http://dnr.wis.gov/org/water/wm/nps/stormwater/techstds.htm#Construction>
2. Construct and maintain all erosion and sediment control measures in accordance with the WDNR's Stormwater web page of technical standards @ <http://dnr.wis.gov/org/water/wm/nps/stormwater/techstds.htm#Construction>
3. Install sediment control measures prior to any grading or disturbance of existing surface material. Adjust all sediment control measures to meet field conditions at the time of construction.
4. Provide weekly inspection and maintenance of all sediment control structures to ensure intended purpose is accomplished. Maintain documentation of inspections per the project special provisions. Sediment control measures are to be in working condition at the end of each working day.
5. In addition to weekly inspections, inspect sediment control structures for integrity after any rainfall of 1/2" or greater and correct any damaged structures.
6. Do not remove sediment control measures until the areas served have established vegetative cover.
7. Collect tracked soil from paved roads located near the construction site. All streets shall be swept and cleared of all dirt and debris on a daily basis.
8. When Discharging trench water refer to WDNR Technical Standard 1061 for de-watering in order to properly filter water in a settling basin or filtering device prior to release into a storm sewer or stream.
9. Protect storm sewer section basins from run-off with fabric per WDNR Tech Std 1060.
10. Prevent overland flow from leaving the work site by installing straw bale or fabric filter fencing parallel to the contours located downhill from the work area.
11. Sediment control for pipeline construction.
 - a. Place excavated trench material on the high side of the trench.
 - b. Backfill, compact, and stabilize the trench immediately after pipe installation.
12. Temporary seeding areas which land-disturbing activities will not be performed for a period greater than 30 days and requires vegetative cover for less than one year. Permanent seeding and stabilization should be applied within a week of final grade being established.
13. All land disturbance and stabilization for this project will occur between April 15th and September 15th. Warm season seeding can be used during this time period. Should seeding need to be completed after November 15th, a dormant seed must be used. All seeding construction shall conform to WDNR Conservation Practice Standard 1059.

PROJECT SPECIFIC EROSION CONTROL PLAN
City of Waterloo – 2022 Street and Utility Reconstruction

Jefferson Street

A tracking pad must be installed per erosion control plan details on each site prior to construction, and maintained through final stabilization.

Inlet protection must be installed on all existing inlets per the Erosion Control Plan and Details Prior to Construction. Inlet protection shall be installed on all new inlets as they are installed. The locations of existing inlets needing inlet protection are shown on plan pages 10–13.

Leschinger Street

A tracking pad must be installed per erosion control plan details on each site prior to construction, and maintained through final stabilization.

Inlet protection must be installed on all existing inlets per the Erosion Control Plan and Details Prior to Construction. Inlet protection shall be installed on all new inlets as they are installed. The locations of existing inlets needing inlet protection are shown on plan pages 16–17.

E Polk Street

A tracking pad must be installed per erosion control plan details on each site prior to construction, and maintained through final stabilization.

Inlet protection must be installed on all existing inlets per the Erosion Control Plan and Details Prior to Construction. Inlet protection shall be installed on all new inlets as they are installed. The locations of existing inlets needing inlet protection are shown on plan page 19.

Conform To Applicable WDNR Technical Standards

- 1052 Non Channel Erosion Mat
- 1057 Stone Tracking Pad
- 1058 Mulching
- 1059 Seeding
- 1060 Inlet Protection
- 1061 De-Watering
- 1067 Grading Practices for Erosion Control
- 1068 Dust Control

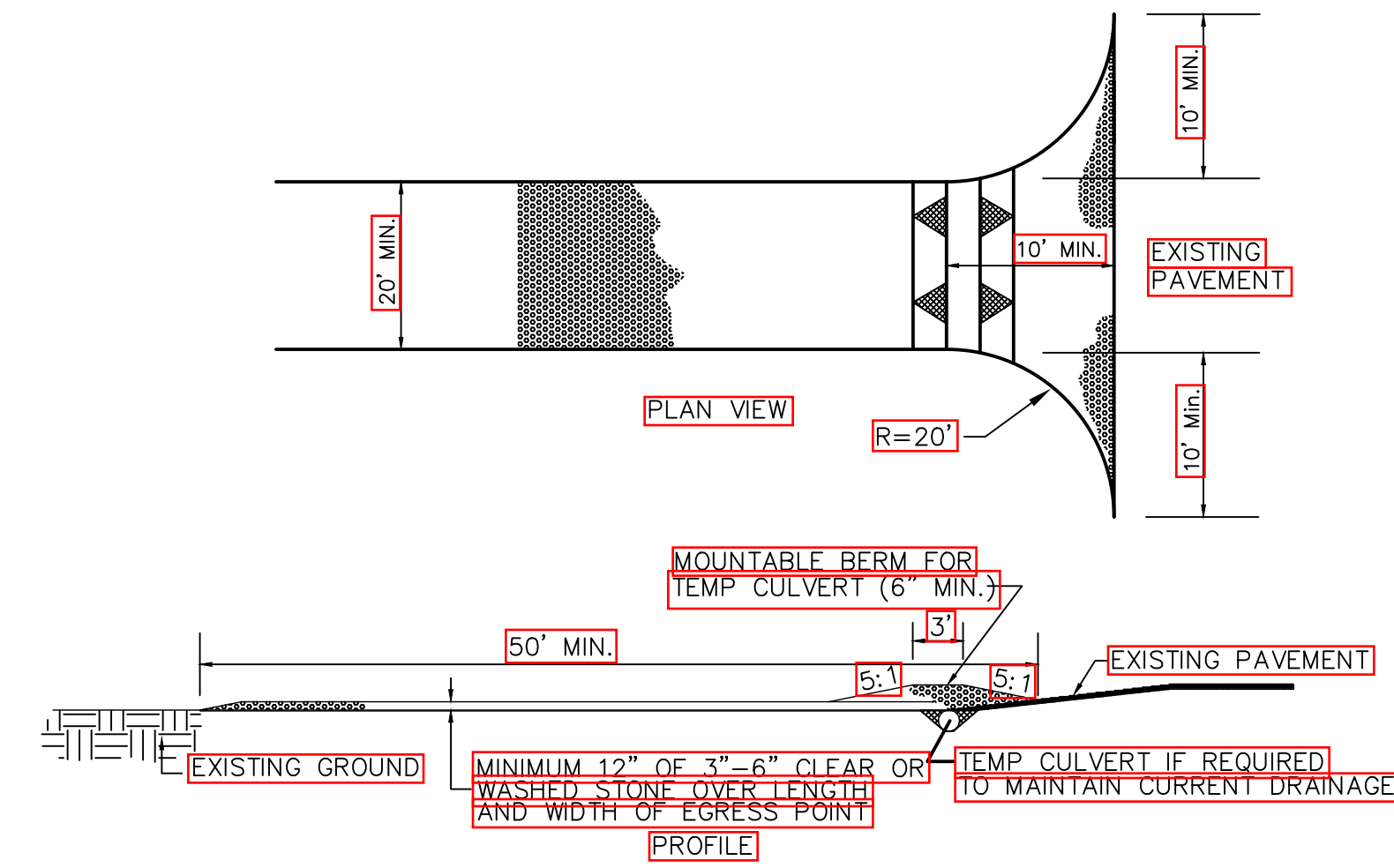

- 1) LOCATION – A TRACKING PAD SHALL BE LOCATED AT EVERY POINT WHERE CONSTRUCTION TRAFFIC ENTERS OR LEAVES A CONSTRUCTION SITE. VEHICLES LEAVING THE SITE MUST TRAVEL OVER THE ENTIRE LENGTH OF THE STABILIZED CONSTRUCTION ENTRANCE.
- 2) SURFACE WATER – ALL SURFACE WATER FLOWING TO OR DIVERTED TOWARD CONSTRUCTION ENTRANCES SHALL BE PIPED THROUGH THE ENTRANCE. MAINTAINING POSITIVE DRAINAGE. PIPE INSTALLED THROUGH THE STABILIZED CONSTRUCTION ENTRANCE SHALL BE PROTECTED WITH A MOUNTABLE BERM WITH 5:1 SLOPES AND MINIMUM OF 6" OF STONE OVER THE PIPE. TO BE SIZED ACCORDING TO THE DRAINAGE. 8" MINIMUM WILL BE REQUIRED.
- 3) MAINTENANCE – TRACKING PAD SHALL BE INSPECTED DAILY AND REPAIRED OR REPLACED IMMEDIATELY.
- 4) REMOVAL – SITE STABILIZED/SEEDED/PAVED AS PER SPECIAL PROVISIONS.

TRACKING PAD / STABILIZED CONSTRUCTION ENTRANCE

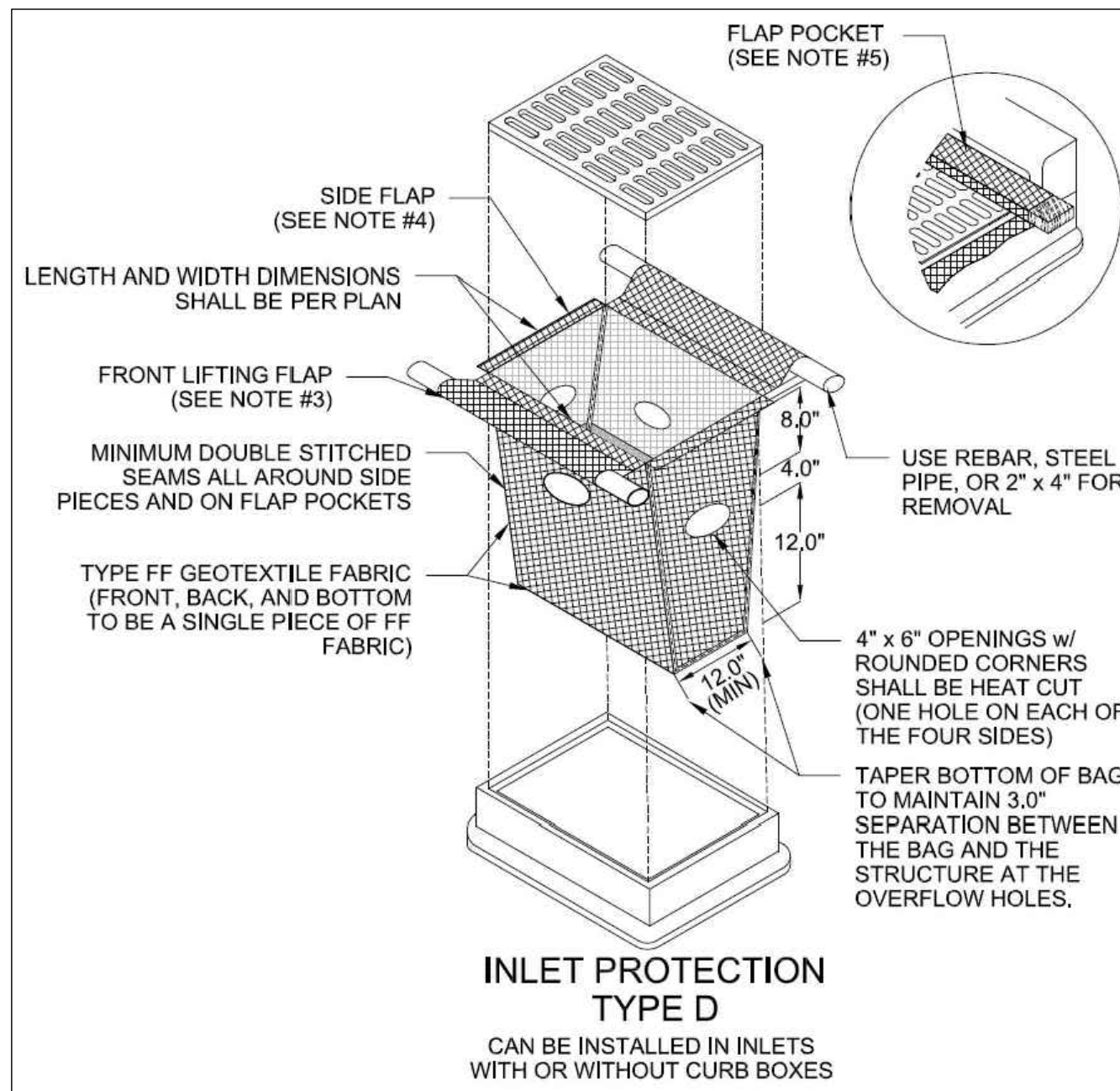

Required Storm Sewer

Inlet Protection Type D

Inlet Protection Type D shall be installed in accordance with WDNR Technical Standards 1060. Inlet protection is to be installed on all existing and installed inlets in the project limits as shown on the paving plans or as directed by owner/engineer. Inlet protection for new or replacement inlets is to be installed as they are installed.

Notes:

1. Taper bottom of bag to maintain three inches of clearance between bag and structure, measured from the bottom of the overflow openings to the structure wall.
2. Geotextile fabric type FF for flaps, top and bottom of outside of filter bag.
3. Front lifting flap is to be used when removing and maintaining filter bag.
4. Side flaps shall be a maximum of two inches long, fold the fabric over and reinforce with multiple stitches.
5. Flap pockets shall be large enough to accept 2"x4". The rebar, steel pipe, or wood shall be installed in the rear flap and shall not block the top half of the curb face opening.

Maintenance Notes:

1. When removing or maintaining inlet protection, care shall be taken so that the sediment trapped in the fabric does not fall into the structure. Material that has fallen into the inlet shall be immediately removed.

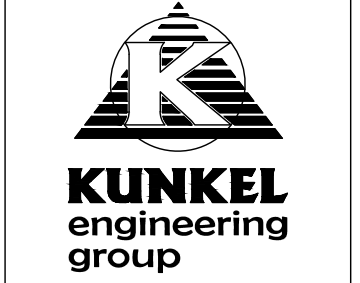

107 Parallel Street
Beaver Dam, WI 53916
(920) 356-9447
Fax (920) 356-9454

| | | | | |
|------------------|--------|-----------|--------|-----------|
| DESIGNED BY: | DATE: | INITIALS: | DATE: | INITIALS: |
| DRAWN BY: | 6/2021 | JKB | 6/2021 | JKB |
| CHECKED BY: | 6/2021 | ### | 6/2021 | ### |
| APPROVED BY: | 6/2021 | ### | 6/2021 | ### |
| 1st REVISION BY: | | | | |
| 2nd REVISION BY: | | | | |
| ASBUILT BY: | | | | |

NOTE: ALL UTILITIES AND STRUCTURES SHOWN ARE THE PROPERTY OF THE CITY OF WATERLOO. THESE COASTINGS SHALL NOT BE TAKEN AS CONCLUSIVE. VERIFICATION OF THE LOCATION AND DEPTH OF UTILITIES AND STRUCTURES, WHETHER SHOWN ON THESE PLANS OR NOT, SHALL BE ASSUMED TO BE A PART OF THE CONTRACTOR'S OBLIGATION. ANY STREET RIGHT OF WAY LINES OR PROPERTY LINES SHOWN ON THESE PLANS ARE ONLY GENERAL APPROXIMATIONS OF SAID LINES AND SHOULD NOT BE USED FOR ANY PURPOSE WITHOUT FIRST CONSULTING WITH THE CITY ENGINEER OR THE ENGINEER IN CHARGE OF KUNKEL ENGINEERING GROUP.

City of Waterloo, WI
2022 Street and Utility Reconstruction
Erosion and Sediment Control Details

SCALE AS SHOWN:
ENGINEER PROJ NO:
KU21.1024.00
OWNER PROJ NO:
SHEET NUMBER:
22 of 22



City of Waterloo, Wisconsin
PROJECT COST ESTIMATE
City Hall Parking and Pedestrian Walkway Improvements



Base Bid 1: Parking Lot Improvements Cost Estimate

| Quantity | Unit | Item | Unit Cost | Item Cost |
|----------------------------|------|---|-------------|---------------------|
| 1 | LS | Unclassified Excavation | \$55,000.00 | \$55,000.00 |
| 1 | EA | Tree and Stump Removal | \$1,000.00 | \$1,000.00 |
| 510 | CY | Riverbank Stabilization, Medium Rip Rap and Geotextile Fabric Type HR | \$195.00 | \$99,450.00 |
| 500 | SF | Remove and Replace 8" Concrete Driveway and Sidewalk | \$27.00 | \$13,500.00 |
| 200 | SF | Remove and Replace 4" Concrete Sidewalk | \$18.00 | \$3,600.00 |
| 160 | LF | Remove and Replace 30" Concrete Curb and Gutter | \$65.00 | \$10,400.00 |
| 3 | EA | Furnish and Install 2'X5' Detectable Warning Field | \$500.00 | \$1,500.00 |
| 3 | EA | Furnish and Install Pipe Bollards | \$350.00 | \$1,050.00 |
| 10 | EA | Paint Yellow the Existing Pipe Bollards | \$55.00 | \$550.00 |
| 720 | CY | Undercutting and Base Course Material | \$46.00 | \$33,120.00 |
| 1,600 | TN | Aggregate Base Dense, 1-1/4-Inch | \$37.00 | \$59,200.00 |
| 3,800 | SY | Geotextile Fabric | \$2.50 | \$9,500.00 |
| 940 | TN | Hot Mix Asphalt Pavement, 3 LT 58-28 S and 4 LT 58-28 S | \$110.00 | \$103,400.00 |
| 300 | LF | Install Steel Beam Guard | \$75.00 | \$22,500.00 |
| 330 | SY | Landscape Restoration | \$9.30 | \$3,069.00 |
| 2,858 | LF | Epoxy Pavement Markings, 4-Inch White | \$1.50 | \$4,287.00 |
| 9 | EA | Epoxy Pavement Markings, Arrow White | \$250.00 | \$2,250.00 |
| 2 | EA | Epoxy Pavement Markings, Handicap Parking Logo | \$300.00 | \$600.00 |
| 1 | LS | Erosion and Sediment Control | \$13,500.00 | \$13,500.00 |
| 1 | LS | Traffic Control and Access | \$1,000.00 | \$1,000.00 |
| Total of Base Bid 1 | | | | \$438,476.00 |

Alternate 1: Pedestrian Walkway Improvements Cost Estimate

| Quantity | Unit | Item | Unit Cost | Item Cost |
|----------------------------|------|---|------------|--------------------|
| 1 | LS | Unclassified Excavation | \$5,500.00 | \$5,500.00 |
| 5 | EA | Tree and Stump Removal | \$500.00 | \$2,500.00 |
| 1,225 | SF | Remove and Replace 4" Concrete Sidewalk | \$16.00 | \$19,600.00 |
| 160 | SF | Remove and Replace Modular Block Retaining Wall | \$68.00 | \$10,880.00 |
| 190 | SY | Landscape Restoration | \$10.00 | \$1,900.00 |
| 1 | LS | Erosion and Sediment Control | \$1,000.00 | \$1,000.00 |
| 1 | LS | Traffic Control and Access | \$1,000.00 | \$1,000.00 |
| Total of Alternat 1 | | | | \$42,380.00 |

Alternate 2: North Monroe Street Walkway Improvements & Landscaping

| Quantity | Unit | Item | Unit Cost | Item Cost |
|----------------------------|------|------------------------------|-----------|-------------------|
| 210 | SF | 4" Concrete Sidewalk Removal | \$18.00 | \$3,780.00 |
| 110 | SY | Landscape Restoration | \$10.00 | \$1,100.00 |
| Total of Alternat 2 | | | | \$4,880.00 |

Grand Total **\$485,736.00**

City of Waterloo Public Works & Property Committee
Annual Calendar (rev. 7/30/2021)

- Meeting night: 1st Thursday of month at 6:00 pm
- Monthly recurring: (1) review of Capital Projects; (2) monitor defined Progress Measures

| |
|---|
| JANUARY |
| <input type="checkbox"/> Oversight of bid process for future year capital purchases & contract services |
| FEBRUARY |
| <input type="checkbox"/> Notify Mayor of reappointment interest |
| MARCH |
| <input type="checkbox"/> Identify grant application opportunities |
| APRIL |
| <input type="checkbox"/> Mayoral Committee appointments |
| MAY |
| <input type="checkbox"/> Review and realign Progress Measures as needed tying back to Comprehensive Plan |
| <input type="checkbox"/> Update annual calendar |
| <input type="checkbox"/> Tour of municipal facilities |
| <input type="checkbox"/> Public Works Director's Spring facility inspection report (added at Mayor's request) |
| JUNE |
| <input type="checkbox"/> Mayor's 2023 Budget start date. |
| JULY |
| <input type="checkbox"/> Traditional beginning of budget consideration with budget memo to department heads. |
| <input type="checkbox"/> § 53-14 Recommending updated multi-year capital improvement plan to Finance, Insurance & Personnel Committee |
| <input type="checkbox"/> Review DPW future year budget submittal |
| - Operational budget |
| ID Programs & Services provided. |
| - Capital Budget |
| ID Street surface maintenance program |
| ID Street/Utility reconstruction plan |
| AUGUST |
| <input type="checkbox"/> PASER review (Pavement Surface Evaluation & Rating) – A 1-10 rating system for road pavement condition using visual inspection to evaluate pavement surface conditions [NOTE: Updated by KEG in odd years] |
| SEPTEMBER |
| <input type="checkbox"/> Review of municipal facility needs (multi-year) |
| OCTOBER |
| <input type="checkbox"/> Evaluating the municipal solid waste management system; trash-recycling service performance & contract |
| <input type="checkbox"/> Oversight of bid process for future year capital purchases & contract services |
| <input type="checkbox"/> Review of municipal facility needs (multi-year) |
| <input type="checkbox"/> Public Works Director's Fall facility inspection report (added at Mayor's request) |
| NOVEMBER |
| <input type="checkbox"/> Oversight of bid process for future year capital purchases & contract services |
| <input type="checkbox"/> Review of municipal facility needs (multi-year) |
| <input type="checkbox"/> Review of City Forestry Plan |
| DECEMBER |
| <input type="checkbox"/> Oversight of bid process for future year capital purchases & contract services |
| <input type="checkbox"/> Impact fee needs assessment update based on prior months review. |
| <input type="checkbox"/> Review of municipal facility needs (multi-year) |